



**Aluminium Sliding
Patio Doors**

 **Value doors[®]**
& windows



Aluminium Sliding Patio Doors

Discover uninterrupted views with Aluminium Sliding Patio Doors from Value Doors & Windows.

Transform your home with our striking aluminium patio doors, elevating both aesthetics and your property's value.

The innovative design of our sliding door system boasts exceptional thermal efficiency and ultra-sleek profiles, maximising the glass area while minimising visible framework.

Experience effortless operation with our engineering-grade hardware, ensuring seamless opening and closing of the sliding doors for many years to come.

Rest assured as our doors undergo rigorous European safety testing and are powder coated to Qualicoat standards, providing ultimate peace of mind that your patio doors are built to last and designed to perform.

ULTRA-MODERN, ULTRA-SLIM



With features designed specifically for the UK market, our patio doors also offer excellent thermal performance, with impressive U-values as low as 1.4 U/m²K. The doors are also proven to improve noise reduction and are fitted with the highest security features, exceeding PAS24:2022 standards.

The sliding patio door has been designed to accommodate multiple glazing options including double or triple-glazed units and blinds in glass. Innovative engineering allows for large expanses of glass to create a striking visual impact.

COLOURS

Our doors are available in three standard colours, plus two dual colour options.

For projects requiring bespoke coloured doors, any RAL colour can be available upon request.

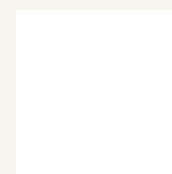

White
RAL 9016



Grey
RAL 7016



Black
RAL 9005



Grey Out/
White In



Black Out/
White In



Bespoke RAL
colour

If you're looking to enhance the aesthetic appeal and functionality of your home, aluminium sliding patio doors are the perfect solution. Whether you have a beautiful garden or a cosy balcony, these doors allow you to bring the outdoors inside with ease.

The doors are designed for large opening sizes, achieving market-leading sash sizes of up to 2.5m x 2.7m per pane.

Create your perfect Patio Door



Maximum Weatherproofing

Designed specifically for the UK market, our patio doors have been built to withstand extreme weathering.

The doors have two levels of channelling water with rubber tubular gaskets to provide a robust seal and improved drainage. A PVC rail cover also increases thermal insulation and water protection.

Optimum Vision

Achieving market-leading sash sizes, the doors can be made to impressive sizes of up to 2500mm x 3000mm per sash.

Endless Possibilities

There is a perfect solution for every project with our sliding door system.

Choose from a wide variety of configurations, depending on the number of panes chosen and which panes you would like sliding or fixed.

Low Maintenance

Our low-maintenance aluminium doors are strong, durable and highly corrosion-resistant. They don't need painting or staining to keep them weather-proof, and they will never rot, peel or flake.

Glazing Options

Our Sliding Patio Doors elegantly frame and enrich outdoor areas while infusing your indoor space with natural light. Transforming entire walls into seamless expanses of glass, our doors offer unparalleled accessibility and a peaceful blend between the indoors and outdoors.

Tailor-made to your bespoke needs, our range offers double and triple-track options, enabling versatile opening configurations to suit your unique preferences. Select from our range of glazing options to complement any property style. Integral blind options are also available.

Low E Double Glazing

Double glazing with toughened clear Low-Emissivity filled with argon gas which has a U-Value of 1.2 w/m²K.

Ultra Low E Double Glazing

An alternative to triple glazing, which can make doors heavy due to the extra weight. Ultra Low E has the same U-value as triple glazing (1.1 w/m²K).

Triple Glazing

Our triple glazed units offer optimum protection and thermal efficiency benefits, achieving a U-Value of 1.1 W/m²K.

Solar Control Glass

This type of glass uses a solar control coating, which is blue tinted, to give protection against UV rays which can cause damage over time in sunny areas to items such as furniture. It can deflect the sun rays to help overheating in sun trap areas when your doors are closed.

Patterned Glass

We have a number of patterned glass options available. If you have one in mind please let us know, as the price and specification depend on the option.



Integral Blinds

Integral blinds can also be incorporated between the double-glazed units, which means they won't get damaged and will never need dusting. The blinds provided can be supplied in a range of colours, as well as the option of a Venetian or pleated blind.

There are three different methods of operation for the Uni-blinds, depending on your requirements and budget:

- Solar Power Uni-blinds
- Electric
- Magnetic Slider

Integral Blinds are offered with a five year manufacturing guarantee against faults. We use Morley Glass, widely recognised as the best quality blinds in glass units available.

Please note, Integral Blinds are only available for panes of glass up to 2m², making them suited only for smaller sized sliding doors.

Manually operated blinds utilise a magnetic device to allow the blinds to be adjusted with ease however required. Available for both Venetian and pleated integral blinds.



Venetian blinds can also be motorised and come with either a wall mounted button or remote control, operating an individual blind or synchronised for up to 12 blinds at once. These can either be wired into the mains or supplied with batteries and solar panels to recharge them.



Pleated available colours:

Pleated blinds come in a range of bold colours each with varying degrees of light reflection.

Venetian available colours:

Venetian blinds offer increased light and solar reflection and come in a range of pastel shades and greys.



DOOR LEAF CONFIGURATION

The Patio Door system has a variety of opening configurations, depending on how many panes are chosen and which panes you would like sliding or fixed.

There is a perfect solution for every project.

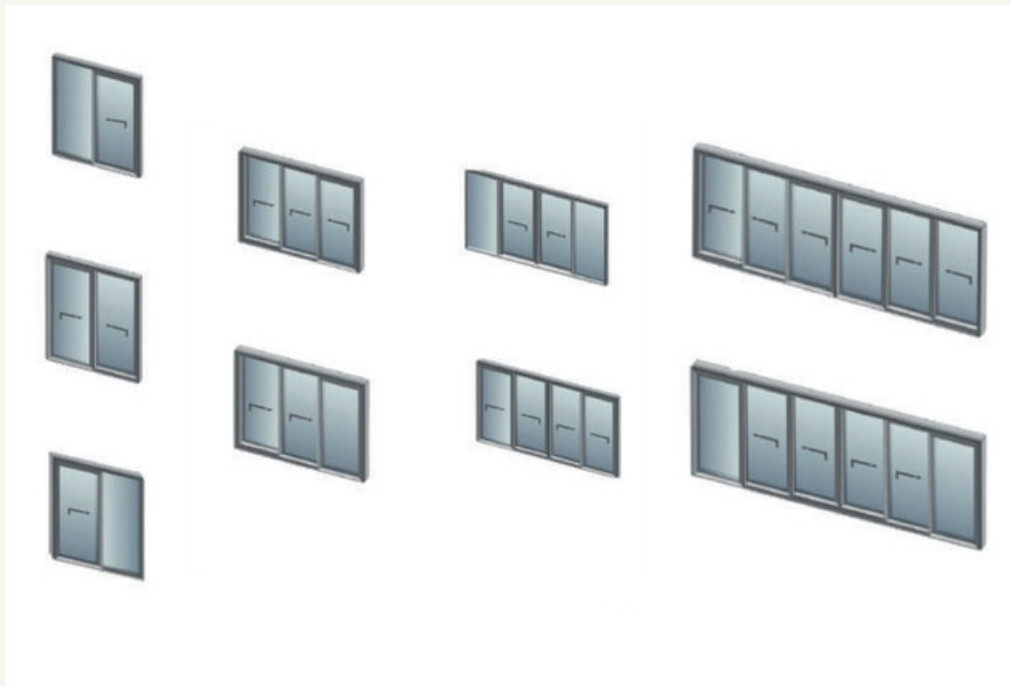

Engineering
Grade
Hardware

PAS24:2022
Compliant

Smooth
Operation

HARDWARE

Secure Your Peace of Mind

The ultra-secure 3-star barrel provides double the sacrificial protection, made from materials 25% denser than iron and with twice the number of pins than the average lock (including an antipick pin) and 20-point drill protection as standard.

If attacked, the barrel enters 'lockdown mode', meaning the lock is practically impenetrable without heavy and noisy power tools.

The locks are also approved by the Police security initiative "Secured by Design" and are tested by the Master Locksmith Association, passing with the Sold Secure Diamond grade, known as one of the highest standards of security UK locks can conform to!



D Handle



Polished Chrome

The D handle is a versatile handle, designed to suit a range of properties and architectural styles. Available with inline sliding operating doors, the handle is available in 6 elegant colours to suit your doors.



Black



White



Polished Gold



Smokey Chrome



Smooth Satin

316 Patio Door Handle

This contemporary sliding door handle is the premium choice for inline sliding doors. Available in both Black & Stainless Steel colour options.

Manufactured from 316 Marine Grade Stainless Steel, the handle is designed for ultimate durability, including where corrosion levels are high such as coastal environments.



316 Lift & Slide Handle

Also manufactured using 316 Marine Grade Stainless Steel, this sleek handle is designed to smoothly operate sliding doors using the lift & slide system.

Effortlessly lifting up and down to operate the doors, the handles showcase a modern look with ultimate durability. Available in both Black & Stainless Steel colour options.



Technical Information

At Value Doors & Windows, our patio doors are made to your unique requirements. From choosing the amount of panes, to colours and configurations, there are many ways you can customise your door.

Take a look at the technical information to help decide how to find your home's perfect fit.

Typical sizes (standard)

Max door leaf width	2500mm
Max door leaf height	3000mm
Max weight (Lift & Slide)	250kg
Max weight (Inline Slider)	210Kg

Technical Details at a Glance:

- Market-leading maximum sash sizes of 2500mm x 3000mm.
- Maximum security – PAS24:2022 compliant.
- Maximum insulation value – down to 1.4 U W/m2K.
- Maximum weather proofing – tested to BS6375 Part 1 : 2009.
- Single or dual colour. Factory powder coated to marine quality as per

Qualicoat regulations.

- 250kg per door leaf providing for the openings.
- Double track (120mm) or triple track (183mm) options available.
- Multi-point locking as standard for the ultimate defense.

SUPER-SLIM INTERLOCK



Average U-values	
CEN Standard (Double Glazed)	1.6 W/m ² K
CEN Standard (Triple Glazed)	1.4 W/m ² K
Glazing	
Glass Thickness	up to 32mm
Sash Profile Options	
Interlock options	25mm or 50mm
Testing	
Energy rating (WER)	C
Security	PAS24:2022 & Secured By Design
Specification	
Visible Sightline Frame/Sash	117mm
Track Options	Double / Triple
Air Permeability	600PA
Water Tightness	300PA
Wind Load Resistance	Class C2/B

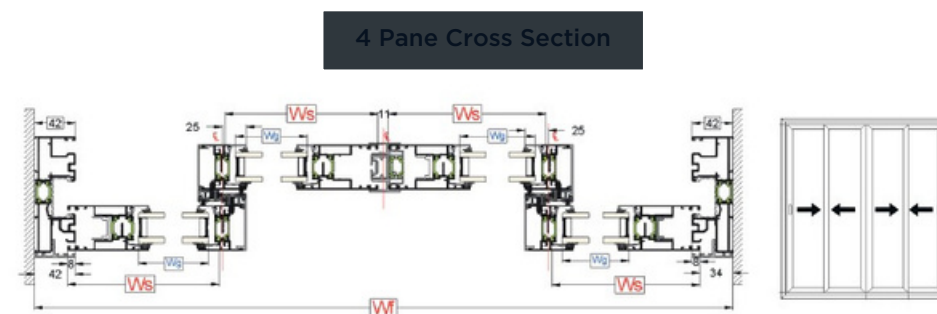
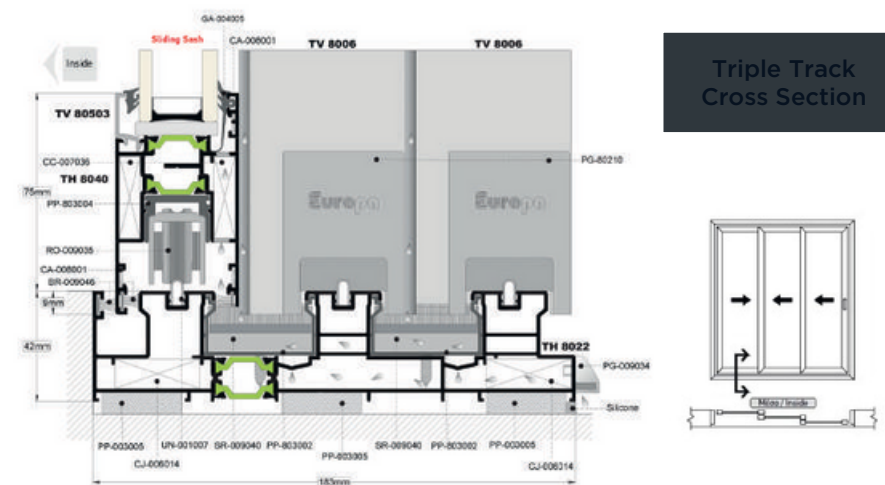
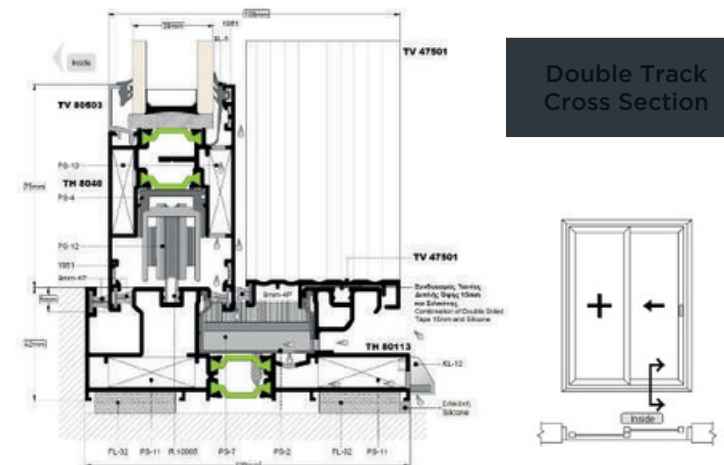

PATIO PROFILE DETAILS

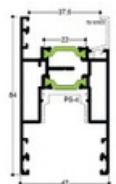

Sash Profile

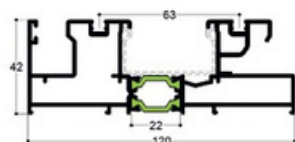

Double Track

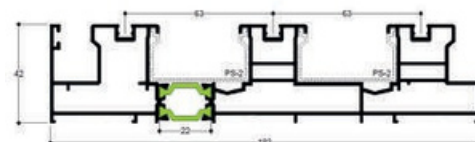

Triple Track



Value doors[®]
& windows

Value Doors & Windows
17 Navigation Court,
Calder Park
Wakefield
WF2 7BJ

Sales@valuedoors.co.uk
www.valuedoors.co.uk
Phone 020 4587 8300